



Leonardo DaVinci High School #212



Who is DaVinci?

- Leonardo da Vinci High School has successfully created an environment in which students are comfortable being themselves and are given the ability to understand the world in which they live surrounded by a school family of supportive, positive, and understanding peers and adults. We are a diverse community in search of excellence.
- Leonardo da Vinci High School is a college – preparatory high school, located on the campus of our partners, D'Youville University. Students complete a rigorous curriculum which includes four years of science and math, with the expectation that students will earn a Regents Diploma with an Advanced Designation. In addition, students take fully accredited College courses. The school consistently has a 95%+ graduation rate year after year that demonstrates the commitment of the teachers, staff and parent partners.

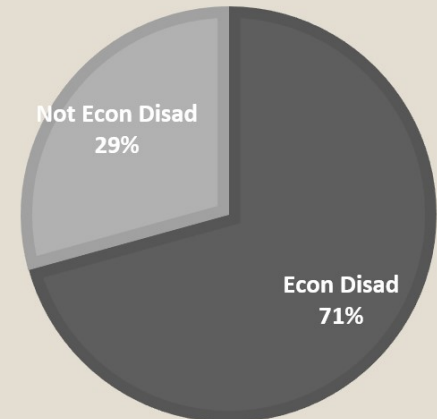
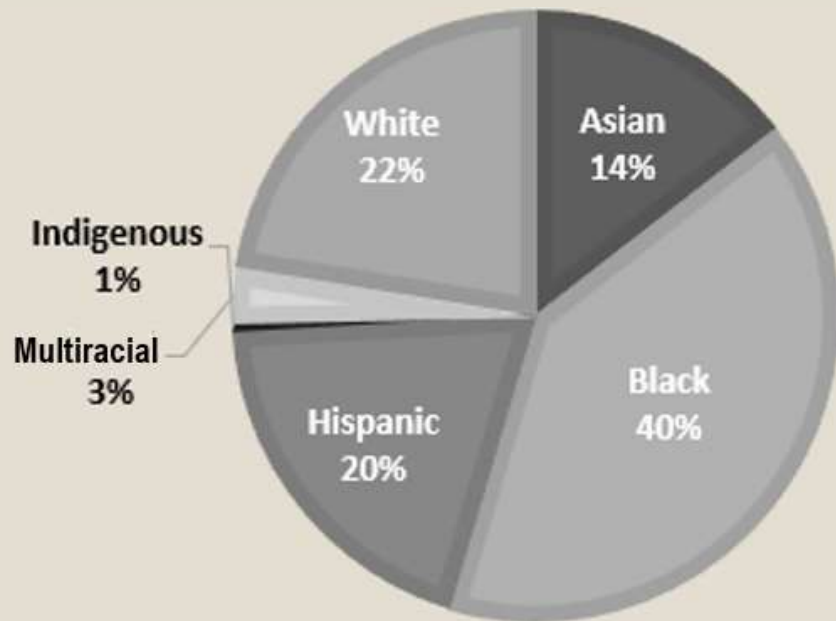
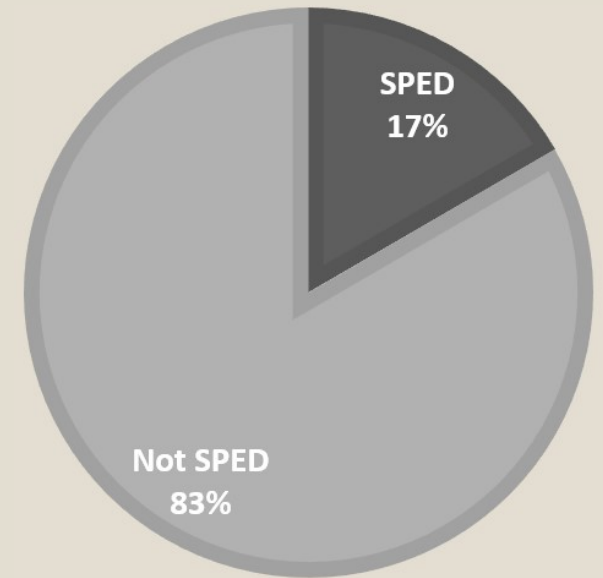
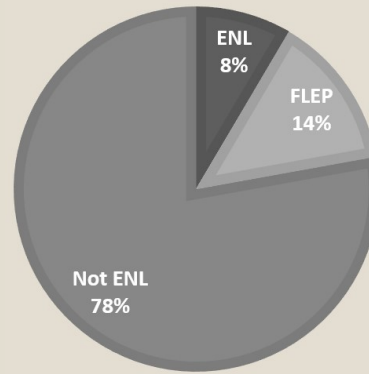
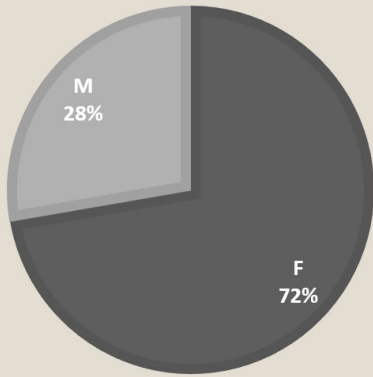



Apply to a 4-year university

● 59%

Take time off to consider my options

● 16%

Apply to a 2-year university

● 14%

Other

● 7%

Enlist in the military

● 3%

Enter the workforce

● 2%



68%

**of students nationwide
attend college post-
graduation (2012-2019)**



67%

**of BPS students attend
college post-graduation
(2015)**



82%

**of daVinci students
attend college post-
graduation (2012-2019)**

- daVinci consistently outpaces national and local averages of students attending either 2-year or 4-year college programs after high school

College/University	Total daVinci Graduates Enrolled (2012-2019)	% Retained Year 2
Erie Community College	152	68%
Buffalo State University	93	72%
Medaille College	71	65%
D'Youville College	60	72%
University at Buffalo	49	86%
Canisius College	35	66%

- daVinci students exhibit fairly high persistence rates, regardless of the college they attend
(Nat'l. avg. approx. 67%)

How did we get here?

- The 15-year lease ended in 2018 and we were operating under 1-year extensions until terminating language was built into the current extension.
- The shift to Division II required DYU to eliminate the pool and limited availability of the gym for DaVinci.
- Limitations of facility, even with renovation left the school with long term challenges.
- The academic partnership did not provide transferable credits.
- A dwindling sense of collective purpose and partnership with the campus partners due to evolution of each institution's context.

What kind of students are most successful are daVinci?

Students said....

All students
can be
successful
here

Kind
students

**Students who
work hard**

Smart/
brainy
students

**Students
who pay
attention**

Focused
students

Teachers/Staff said...

All students can be
successful here

**College bound
students**

Ambitious
students

Hardworking
students

What's special about daVinci? (combined question responses)

Students said...

**Diversity/
Inclusivity**

**Being on a
college campus**

It's small

**People are nice
(no drama/
bullying)**

Art classes

How do you think daVinci's location on the campus of DYC impacts education?

Students, Staff, and Parents, said...

Promotes
maturity

Provides unique
and valuable
opportunities

Provides
introduction/
preparation
for college

It
doesn't

Limits
opportunities

Motivates
students

Do you have any ideas for how daVinci could make the high school experience better?

Students said....

**Curriculum changes:
Music, AP classes,
Languages, Study Halls**

**More
events/
school
activities**

**More space
(gym/pool access,
bigger classrooms)**

**More clubs/
extracurriculars**

**More athletic
opportunities**

What is the next best step?

- The current trajectory is largely informed by the work of external consultants that conducted surveying and focus group sessions. Key constituent aspirations were:
 - Campus location
 - College Credit Opportunities
 - Independent gym and auditorium
 - Larger classroom space
 - Opportunities for arts and music

Academic Partnership

- 4 Pathways
 - Fine and Creative Arts
 - Life Sciences Foundations
 - Teacher Academy
 - Communications and Public Relations
 - Other buffet options

Academic Partnership

- Opportunities for up to 5 courses for dual credit courses.
- 2 to 4 courses from the Buffalo State College Catalog in designated pathways, elective, or SUNY general education options.
- Leverage existing Advance Placement options for World History and Environmental Science or Anatomy,
- Opportunities for non-Credit volunteer service.
- Potential for 27 to 33 credits.



Configuration

- Full Gym and Locker Rooms in Building D
- Full Auditorium in Building E
- 3rd Floor of Building A
- Parking
- Proximity to Burchfield and AKG
- Room for Specials and Yellow Bus drop off
- Close to Delaware and Elmwood metro routes.



Site Considerations

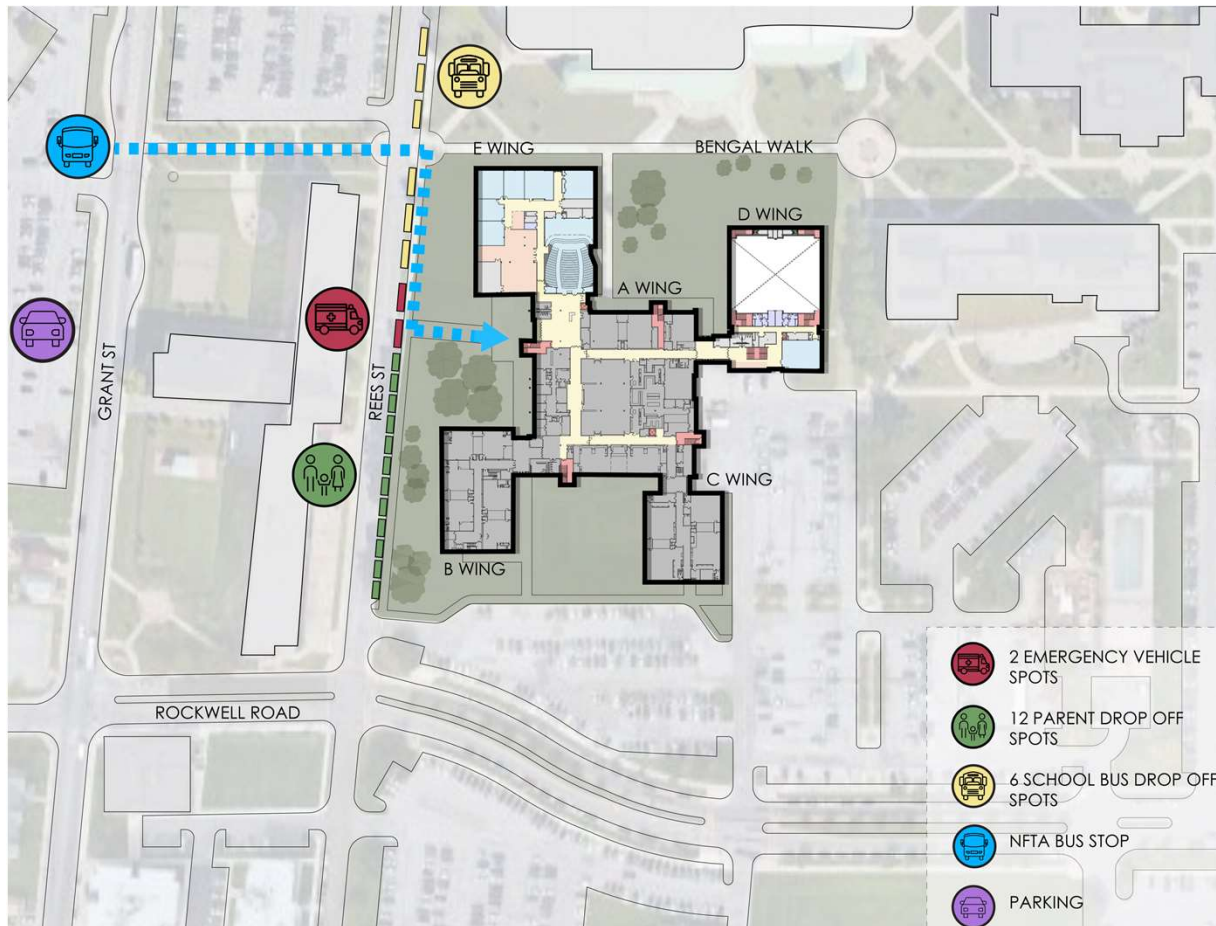

Why Buckham Hall works

- Location
- Existing amenities (gym, aud, it is a school!)
- Positive relationship between BSC & BPS
- Safety – BSC has their own state police unit

What are the challenges

- 21st century learning environment in a 60yr old building
- Change of Occupancy
- Infrastructure (systems and envelope)
- Health and safety (hazardous materials and accessibility)

Design Approach

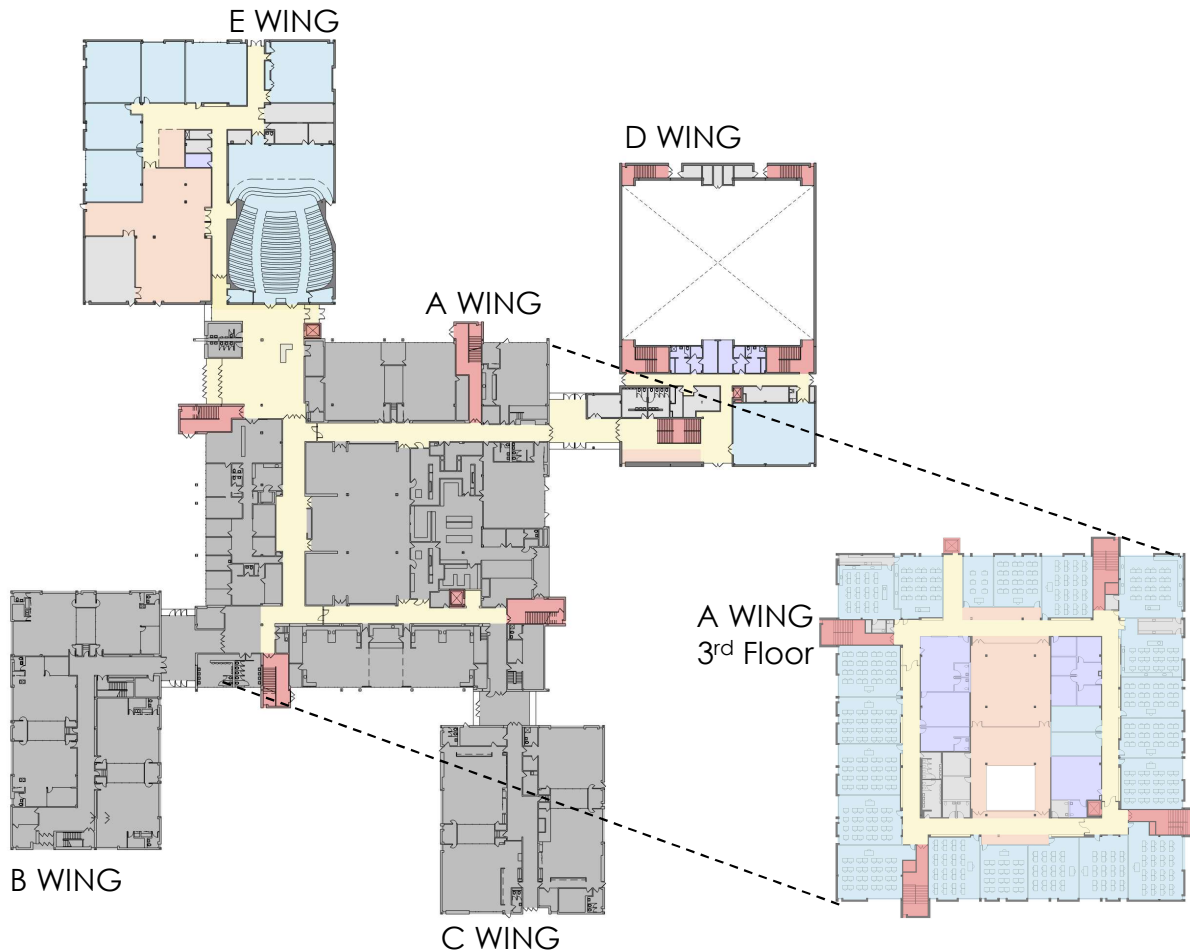

Minimal Construction Impact

- Less programmatic opportunities
- Less accessible
- **20** classrooms
- Minimum state aid
- **16month** construction duration

Maximize the DaVinci Program

- **26** right-sized classrooms
- Maximize state aid
- **16month** construction duration